



Garnon Mead, Coopersale, CM16

£315,000 Guide Price



Property Description

A wonderful one bedroom apartment with garden, perfectly positioned in Garnon Mead, Coopersale.

Looking for your first buy, or perhaps the perfect downsize? Then look no further. This superb home, peacefully tucked away in Coopersale, is packed with all you could need for a great place to call home.

Inside you will find a smartly formed kitchen, designed with sleek fitted cabinets ready for you to unpack all your pots and pans. You'll also find a double bedroom and a fabulous bathroom, complete with built-in vanity unit and walk-in rainhead shower. We love the gorgeously bright back-lit mirror - a great addition for getting ready in the mornings. Elsewhere, the lounge/diner is blessed with plenty of natural light and provides great space for your chosen furniture and layout. From here step outside into your very own private garden. A real bonus for any apartment, this garden simply is the cherry on top! Lovingly landscaped, it's low maintenance yet superbly formed. Light up the bbq, invite your friends over and soak up the sun! A great space to love and enjoy.

Garnon Mead is quite simply a perfect location. Sitting in the village of Coopersale, from here you are moments from fantastic forest walks or maybe a quick glass of your favourite tippable at the delightful Garnon Bushes. With a very special community feel, a parade of convenience shops and a short drive or walk into Epping, Coopersale is a wonderful spot to call home.

EPC Rating: C



Key Features

- ✓ SECLUDED LOCATION
- ✓ LANDSCAPED GARDEN
- ✓ ALLOCATED PARKING
- ✓ LONG LEASE
- ✓ NEWLY FITTED SHOWER ROOM
- ✓ CLOSE TO FOREST
- ✓ IDEAL DOWNSIZE OR FIRST TIME BUY



Rooms

Porch Area

Entrance Area

Lounge/ Diner

12' 10" x 14' 12" (3.91m x 4.56m)

Kitchen

5' 12" x 7' 5" (1.82m x 2.27m)

Space for washing machine, cooker and fridge/ freezer

Bathroom

5' 7" x 7' 5" (1.69m x 2.27m)

Bedroom

11' 5" x 9' 11" (3.49m x 3.03m)

Access to storage cupboard.

External Areas

Garden

Landscaped garden

Allocated Parking

1 Parking Space



All

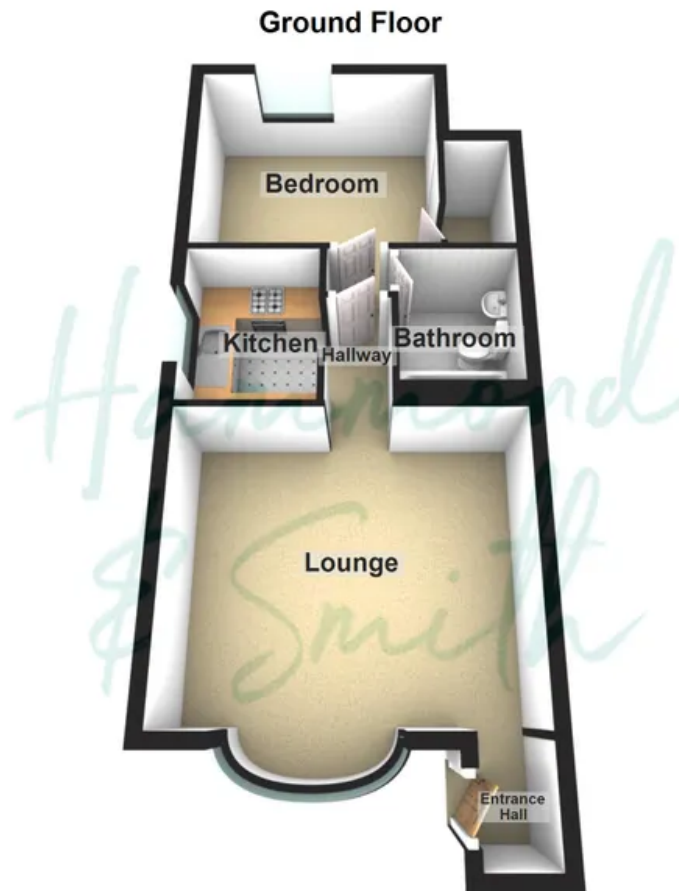

Total area: approx. 43.3 sq. metres (466.3 sq. feet)

Floorplans are provided for guidance only. They are not to scale & must not form any part of a legal contract or be reproduced
Plan produced using PlanUp.

Hammond & Smith

01992 919 007

hello@hammondandsmith.co.uk

