



Rowley Mead, Thornwood, CM16

£255,000 Guide Price

Hammond
& Smith

Property Description

A spacious two bedroom first floor apartment sitting in the heart of Thornwood.

A perfect opportunity for first-time buyers, downsize living or perhaps even an investment purchase, this apartment is equipped with all the ingredients for a wonderful home. The open plan I-shaped living area, zoned by a change in flooring, provides room to relax, cook and entertain. Here you will find a fitted shaker style kitchen with integrated oven and hob. With two bedrooms, the master comes complete with fitted wardrobes, all ready for you to move in an unpack! Completing this apartment, the family bathroom is equipped with heated towel rowel and bath/shower.

The village of Thornwood is in a great spot positioned just outside Epping, with easy access to the M11/M25 and just a 6-minute drive to London Underground's Central Line. A top weekend recommendation from us - enjoy a stroll in the forest followed by a burger of dreams from Munchies Gourmet Burgers, Thornwood on the way home. Enjoy! All told, this is a top place to call home.

EPC Rating: D



Key Features

- ✓ TWO DOUBLE BEDROOMS
- ✓ OPEN PLAN LIVING
- ✓ THREE PIECE BATHROOM
- ✓ TOP FLOOR APARTMENT
- ✓ COMMUNAL GARDENS
- ✓ IDEAL FIRST TIME BUY OR INVESTMENT
- ✓ AMPLE STORAGE



Rooms

Entrance Hall

.

Lounge/ Diner

Kitchen

Bedroom One

9' 7" x 10' 6" (2.92m x 3.19m)

Bedroom Two

11' 9" x 8' 7" (3.57m x 2.62m)

Bathroom

6' 6" x 6' 2" (1.97m x 1.88m)

External Areas

Communal Garden

Off Road

1 Parking Space





All

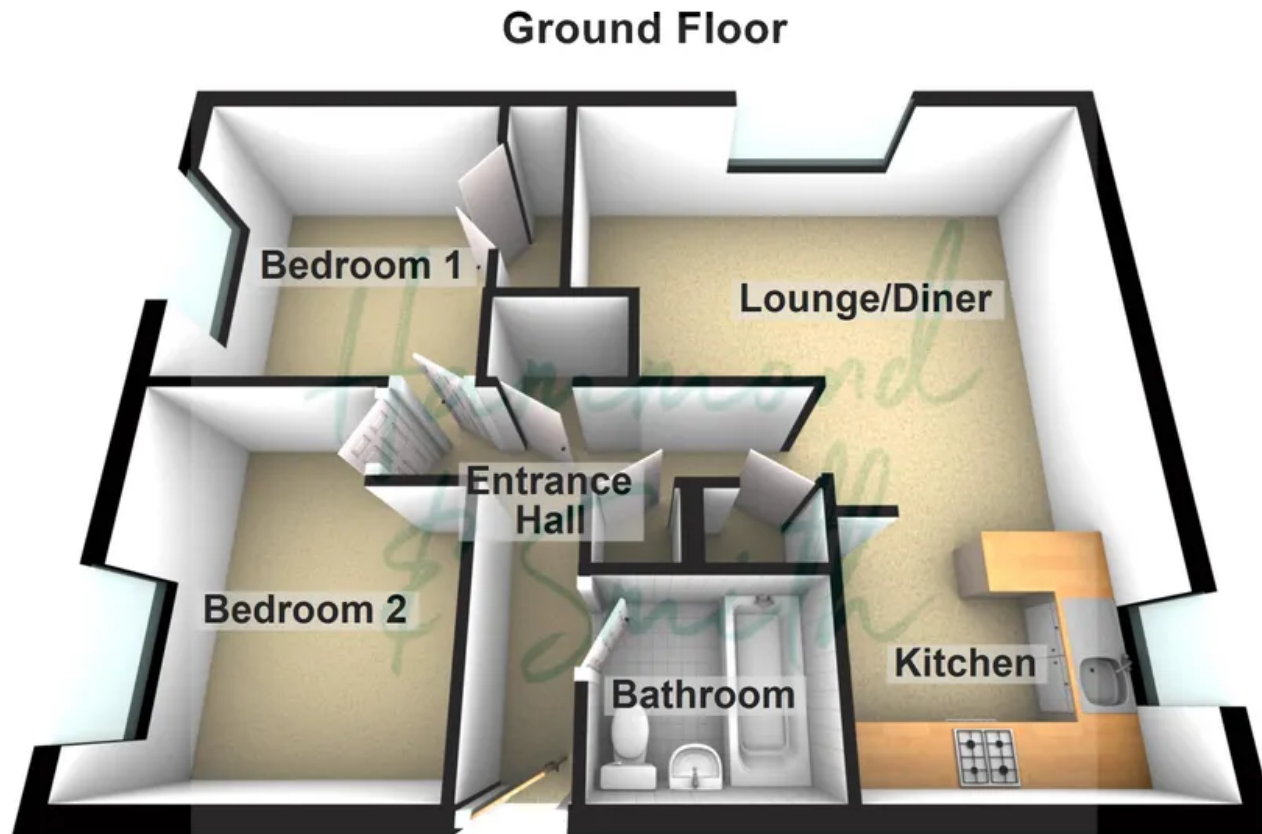

Floorplans are provided for guidance only. They are not to scale & must not form any part of a legal contract or be reproduced
Plan produced using PlanUp.

Hammond & Smith

01992 919 007

hello@hammondandsmith.co.uk

